



Zoning Resolution

THE CITY OF NEW YORK

Eric Adams, Mayor

CITY PLANNING COMMISSION

Daniel R. Garodnick, Chair

Appendix A

File generated by <https://zr.planning.nyc.gov> on 5/20/2024

Appendix A - Special Southern Hunters Point District Plan

LAST AMENDED
11/13/2008

Map 1 – Special Southern Hunters Point District, Subdistricts and Parcels

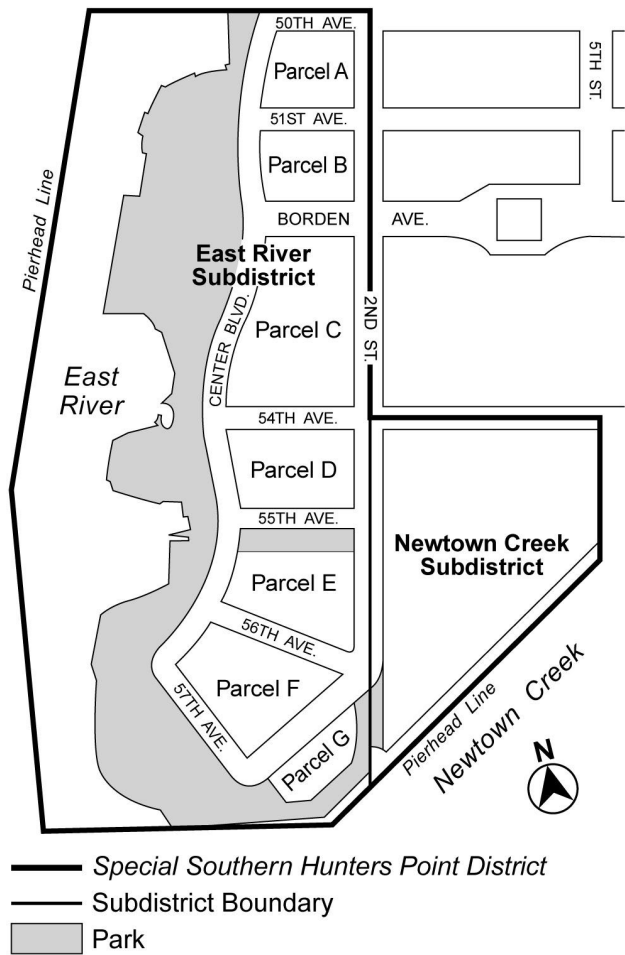

Map 2 – Special Ground Floor Use Regulations

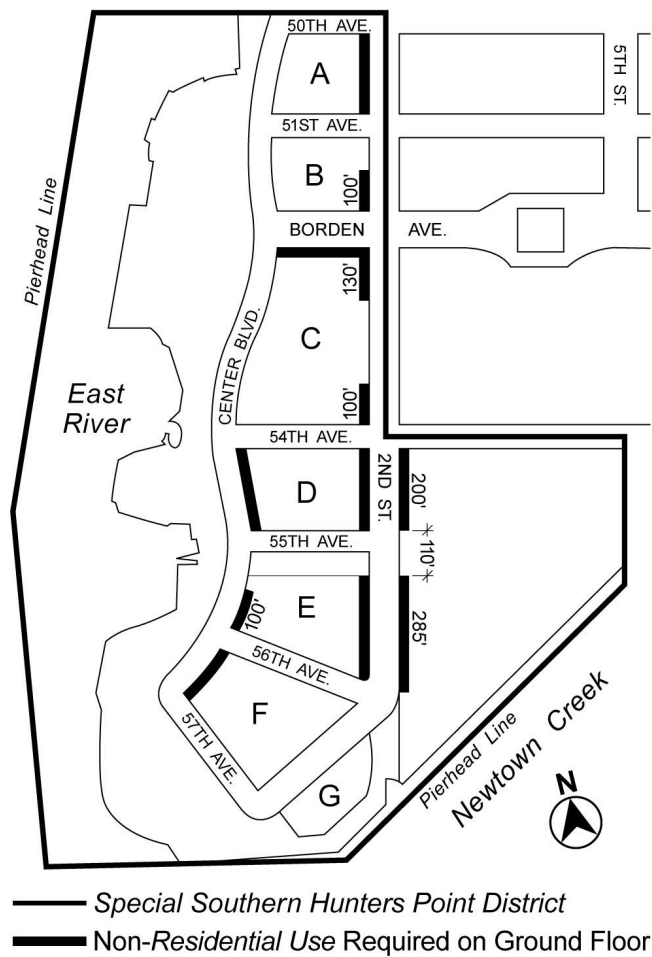

Map 3 – Street Wall Locations

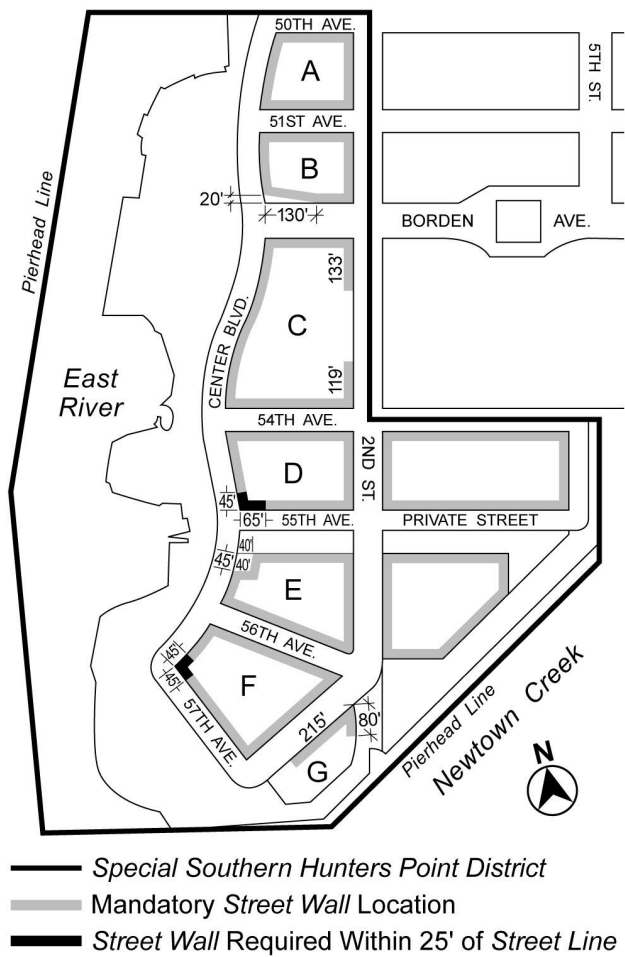

Map 4 – Minimum Base Heights of 40 Feet

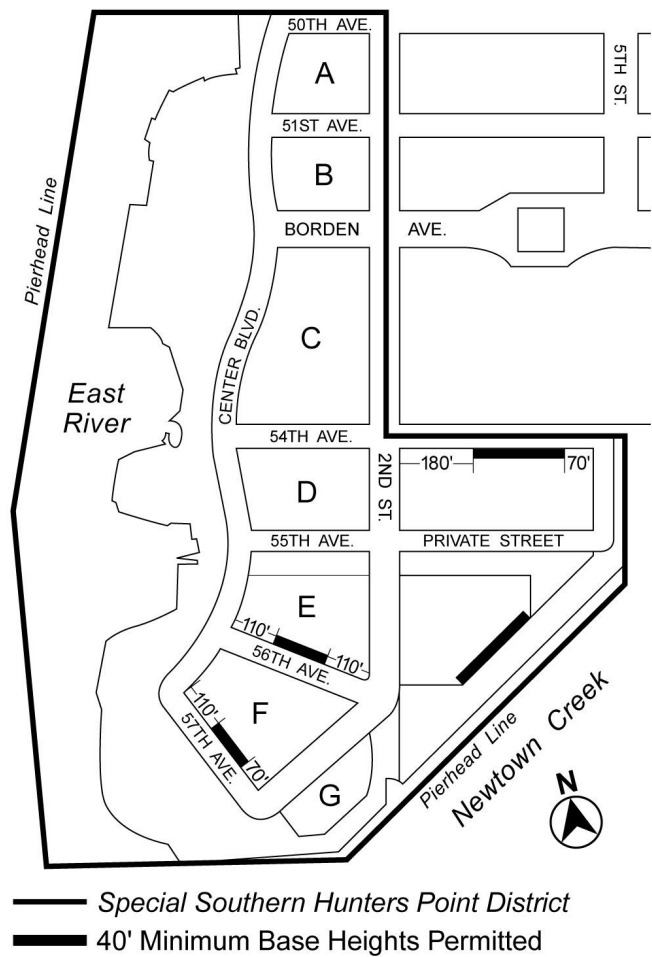

Map 5 – Maximum Base Heights other than 70 Feet

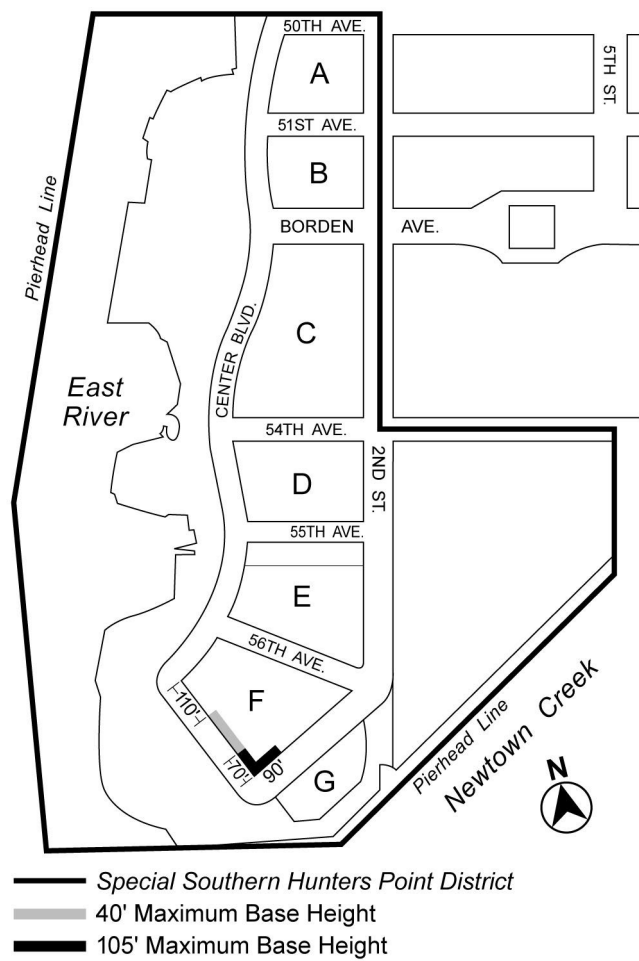

Map 6 – Tower Areas

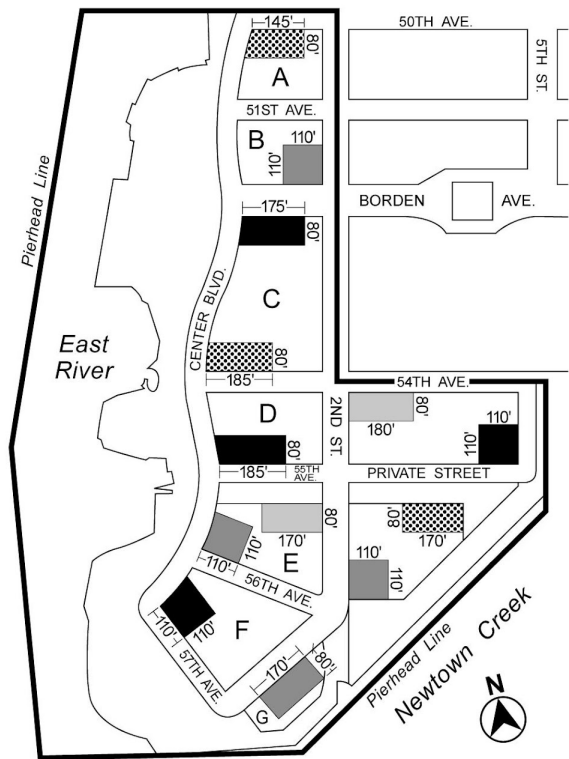

- Special Southern Hunters Point District
- 270' Maximum Tower Height
- 300' Maximum Tower Height
- 350' Maximum Tower Height
- 400' Maximum Tower Height

Map 7 – Mandatory Sidewalk Widening and Publicly Accessible Open Area

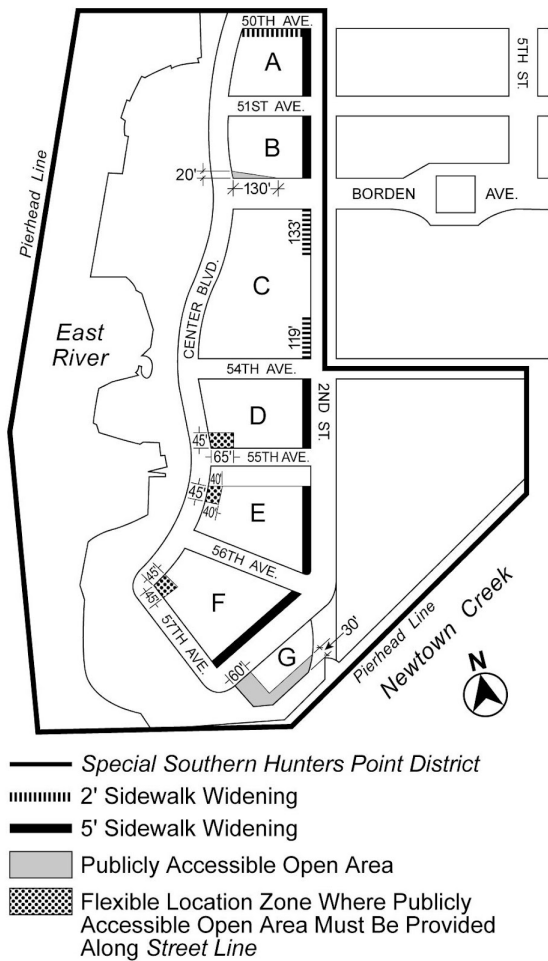

Map 8 – Publicly Accessible Private Street and Open Area in Newtown Creek Subdistrict

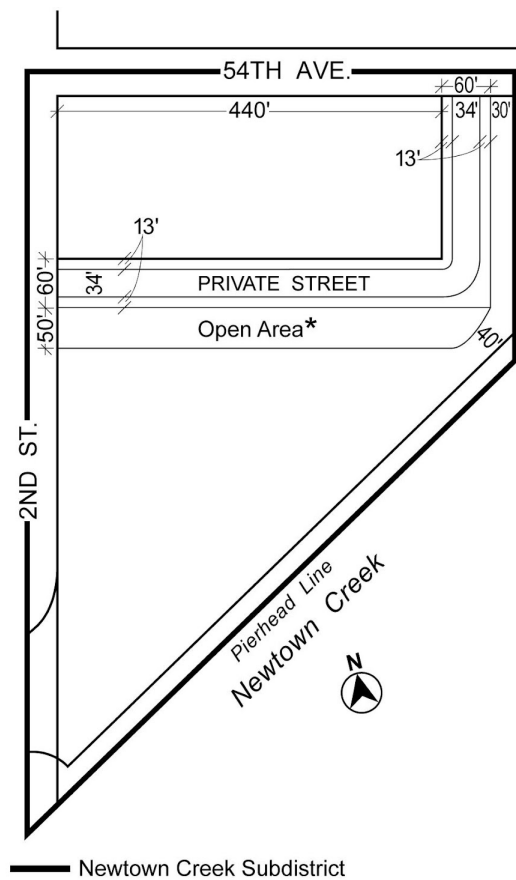

— Newtown Creek Subdistrict

*One 13' wide walkway connecting sidewalk of private street and residential building entrance may traverse Open Area beyond 200' of 2nd St.

Map 9 – Newtown Creek Waterfront Access Plan (Q-3)

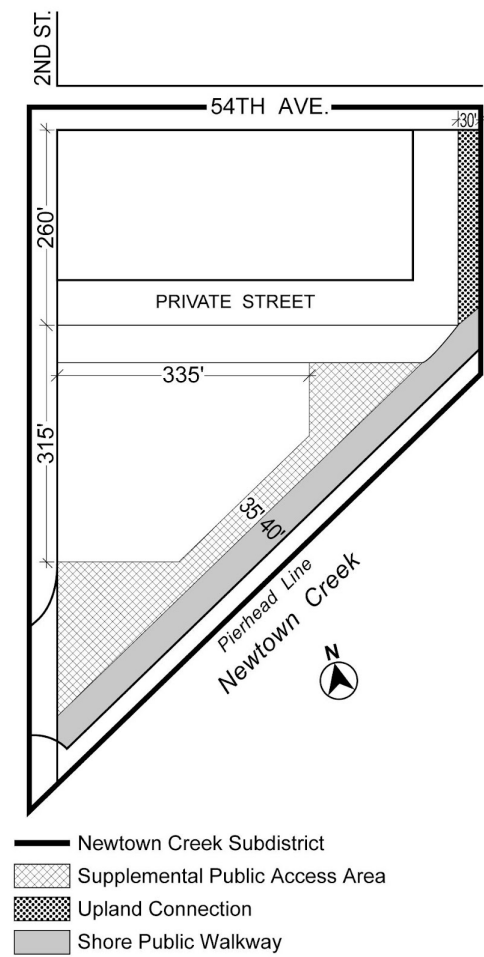

Map 10 – Permitted Curb Cut Locations

